

LEGEND

OBSTRUCTIONS & OBSTACLES

- Identification Number (102)
- Top Elevation in Feet 885'
- Tree(s) or Shrub(s) ✳
- Building ■
- Pole, Tower, Antenna ○
- Spot Height ●
- Transient Z
- Terrain Penetrating Lowest Surveyed Slope ▲

GEOGRAPHICAL FEATURES

- Transmission line(s) -T-T-T-
- Fence Line -|-|-|-|
- Railway Line(s) =
- Airport Boundary ---
- River, Creek ~
- Road, Track —

AMENDMENT RECORD

No.	Date	Endorsed by
1	1/4/2009	Addition of Obstacle 12/2
2	26/4/2015	Addition of 30/05, 30/16, 30/17, 30/04 deleted
3	26/4/2018	Addition of 12/06
4	24/05/2021	Various additions and deletions

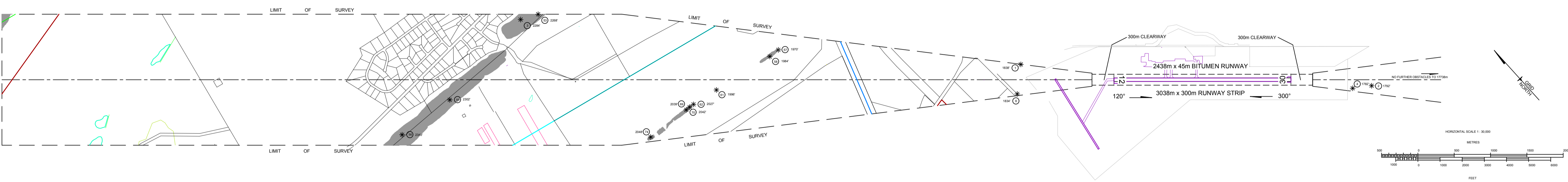
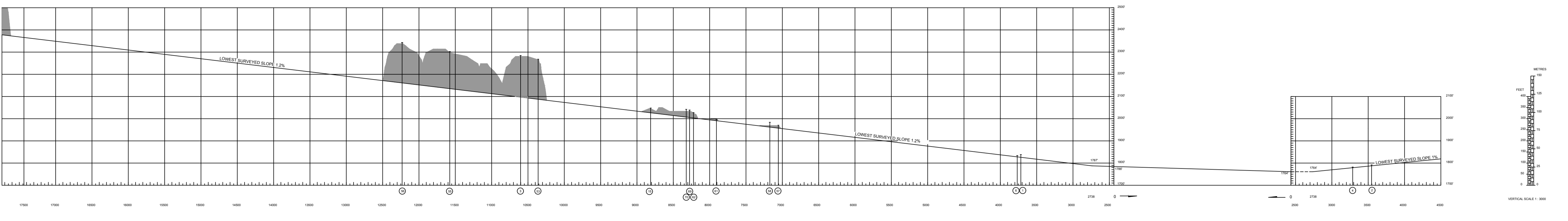

NOTES	
<p>REFER TO SHEET 2 FOR DETAILED OBSTACLE DATA</p> <p>PREPARED BY AIRPORT SURVEYS FOR ALICE SPRINGS AIRPORT</p> <p>BACKGROUND MAPPING SUPPLIED BY LANDS, PLANNING & ENVIRONMENT - NT</p> <p>SURVEYED - B. FITZGERALD APRIL 2021</p> <p>DRAWN - B. FITZGERALD MAY 2021</p>	<p>VERTICAL DATUM AUSTRALIAN HEIGHT DATUM (AHD)</p> <p>HORIZONTAL DATUM MAP GRID OF AUSTRALIA (MGA84) ZONE 53</p> <p>HORIZONTAL DISTANCES ARE IN METRES, ELEVATIONS ARE IN FEET</p> <p>MAGNETIC DECLINATION 4.51', - 0.04 ANNUAL VARIATION AT 24 MAY 2021</p>

RWY 12/30 - DECLARED DISTANCES		
RWY 12		RWY 30
2438	TAKE-OFF RUN AVAILABLE (TORA)	2438
2738	TAKE-OFF DISTANCE AVAILABLE (TODA)	2738
2438	ACCELERATE-STOP DISTANCE AVAILABLE	2438
2438	LANDING DISTANCE AVAILABLE (LDA)	2438

AERODROME OBSTACLE CHART - ICAO ANNEX 4 TYPE A (OPERATING LIMITATIONS)

ALICE SPRINGS AIRPORT, AUSTRALIA

RUNWAY 12/30

NOTE: TO BE READ IN CONJUNCTION WITH CURRENT NOTAMS

ASP/002 SHEET 1 OF 2 - EDITION 5, MAY 2021